

ITEM NO.	QTY.	PART NUMBER	DESCRIPTION
1	2	288402	CAMBER BUSHING
2	4	288403	CAMBER CAM
3	2	288404	SHCS, M12-1.75 x 80, CL 12.9
4	2	83413	HFCLN, M12-1.75, CL10, CAD
5	2	288405	CAMBER SPACER

PART NUMBER IP-350		CAMBER KIT, 1.5 DEG.		
DATE	REV	REVISION HISTORY	DWG	ECN
05/21/09	A	INITIAL RELEASE OF IP	JSP	856

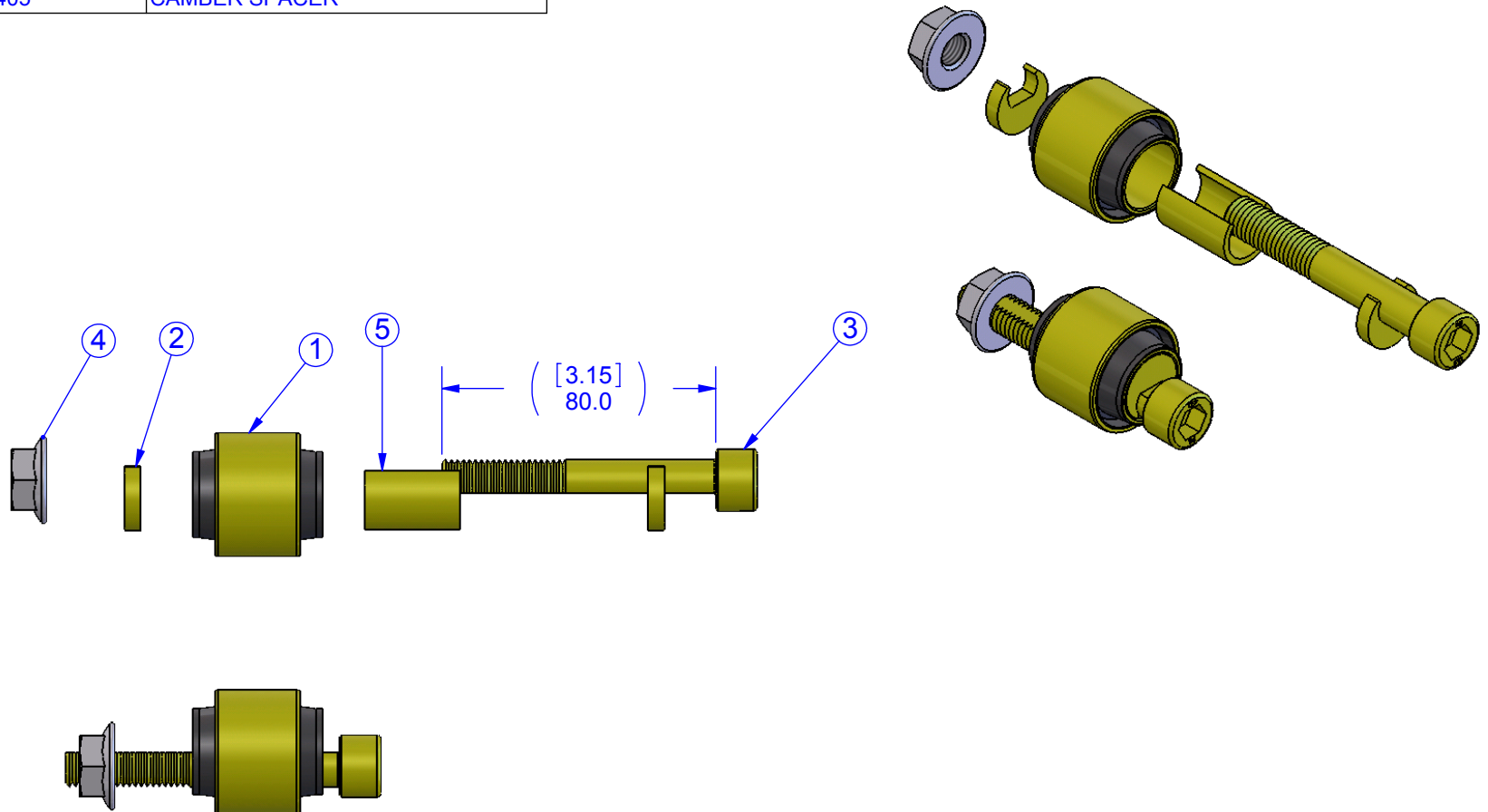

INSPECTION PRINT FOR 288401

THIS DOCUMENT CONTAINS PROPRIETARY INFORMATION WHICH SHALL NOT BE REPRODUCED, TRANSFERRED TO OTHER DOCUMENTS, DISCLOSED TO OTHERS, USED FOR MANUFACTURING OR ANY OTHER PURPOSE WITHOUT PRIOR WRITTEN PERMISSION FROM SPECIALTY PRODUCTS COMPANY.

UNDIMENSIONED FEATURES ARE ±0.5MM UNLESS OTHERWISE SPECIFIED DIMENSIONS AND TOLERANCES ARE IN MILLIMETERS AND DECIMAL DEGREES: X ±1.5, X.X ±0.70, X.XX ±0.25, ANGLES ±2.0° CONFORMS TO ASME Y14.5M-1994



Specialty Products Company™
Longmont, CO 80504

SCALE 1:1	DO NOT SCALE DRAWING	CONTRACT	CHECKED CCH	DRAWN JLB	SIZE A	DATE 05/23/08	REV A	SHEET 1 OF 1
-----------	----------------------	----------	-------------	-----------	--------	---------------	-------	--------------